

HSK – POWER MILL Prihvati

YG-1 TOOLING SYSTEM

POWER MILLING CHUCK

- FRÄSERSPANNFUTTER
- MANDRIN PORTE FRAISE
- MANDRINI PORTA FRESA
- PORTAHERRAMIENTAS PARA FRESADO • FRÄSERSPANNFUTTER
- MANDRIN PORTE FRAISE
- MANDRINI PORTA FRESA
- PORTAHERRAMIENTAS PARA FRESADO



DIN 69871-SK
HIGH-SPEED TYPE / STANDARD TYPE

DIN 69893/ISO 12164-1-HSK
HIGH-SPEED TYPE / STANDARD TYPE

CBT (BT DUAL CONTACT)

JIS B6339/MAS 403-BT
HIGH-SPEED TYPE / STANDARD TYPE

DIN 228-MTA/MTB, R8

MILLING CHUCK SET
STANDARD MILLING CHUCK SET
O.C. MILLING CHUCK SET

ACCESSORY

END MILL COLLET (K, CK, MT, JT)
SPANNER

POWER MILLING CHUCK

HIGH-SPEED POWER MILLING CHUCK

HOCHGESCHWINDIGKEIT'S FRÄSERFUTTER
 MANDRIN PORTE FRAISE À GRANDE VITESSE
 MANDRINI PORTA FRESA PER ALTA VELOCITÀ
 PORTA-HERRAMIENTAS PARA FRESDADO DE ALTA VELOCIDAD

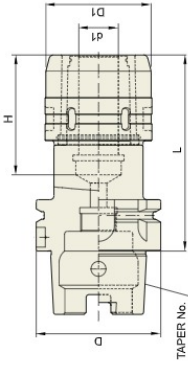

DIN 69893
 -HSK

Taper Accuracy

G Value 6.3

RPM 20,000

Coolant System AD

■ DIN 69893/ISO 12164-1-HSK FORM A

TAPER No.	MODEL No.	EDP No.	d1	D1	L	H	WEIGHT (kg)	Unit: mm
50A	HSK50A-C20-100HS	P2773102	20	54	100	70	1.30	
	HSK63A-C20-105HS	P2562016	20	54	105	70	1.50	
	HSK63A-C25-120HS	P2773103	25	62.5	120	80	2.20	
63A	HSK63A-C32-130HS	P2562017	32	74	130	100	2.70	
	HSK100A-C20-110HS	P2773104	20	54	110	70	3.50	
	HSK100A-C25-130HS	P2773105	25	62.5	130	80	3.80	
100A	HSK100A-C32-135HS	P2773101	32	74	135	100	4.20	
	HSK100A-C42-135HS	P2773106	42	74	135	100	5.30	

▶ CATANIS RS 501 Taper and Linch type products are available.
 ▶ For applicable collet and spanner, please refer to page 154.

POWER MILLING CHUCK

POWER MILLING CHUCK

FRÄSERSPANNFUTTER
 MANDRIN PORTE FRAISE
 MANDRINI PORTA FRESA
 PORTA-HERRAMIENTAS PARA FRESDADO

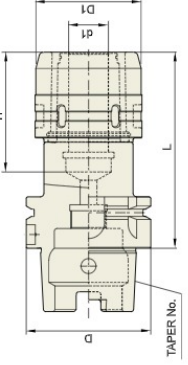

DIN 69893
 -HSK

Taper Accuracy

G Value

RPM

Coolant System AD

■ DIN 69893/ISO 12164-1-HSK FORM A

TAPER No.	MODEL No.	EDP No.	d1	D	D1	L	H	WEIGHT (kg)	Unit: mm
50A	HSK50A-C20-100	P2773151	20	50	54	100	70	1.30	
	HSK63A-C20-105	P2773152	20	63	54	105	70	1.50	
	HSK63A-C32-130	P2600032	32	63	72	130	100	2.70	
100A	HSK100A-C20-110	P2773153	20	100	54	110	70	3.50	
	HSK100A-C32-135	P2773154	32	100	72	135	100	4.20	
	HSK100A-C42-135	P2773155	42	100	92	135	100	5.30	

◆ ACCESSORY

END MILL COLLET

MODEL No.

K20-6, 8, 10, 12, 16

K32-6, 8, 10, 12, 16, 20, 25

K42-6, 8, 10, 12, 16, 20, 25, 32

▶ Special size of Ø3, Ø4 or Ø5 can be produced and supplied upon request.

END MILL COLLET

MODEL No.

CK20-6, 8, 10, 12, 16

CK25-6, 8, 10, 12, 16, 20

CK32-6, 8, 10, 12, 16, 20, 25

CK42-6, 8, 10, 12, 16, 20, 25, 32

SPANNER

MODEL No.

C20 SP

C25 SP

C32 SP

C42 SP

▶ For the EDP No. of collet and spanner, please refer to page 154.