

# **SK – HYDRO Prihvati**

## TECHNICAL INFORMATION HYDRAULIC CHUCK

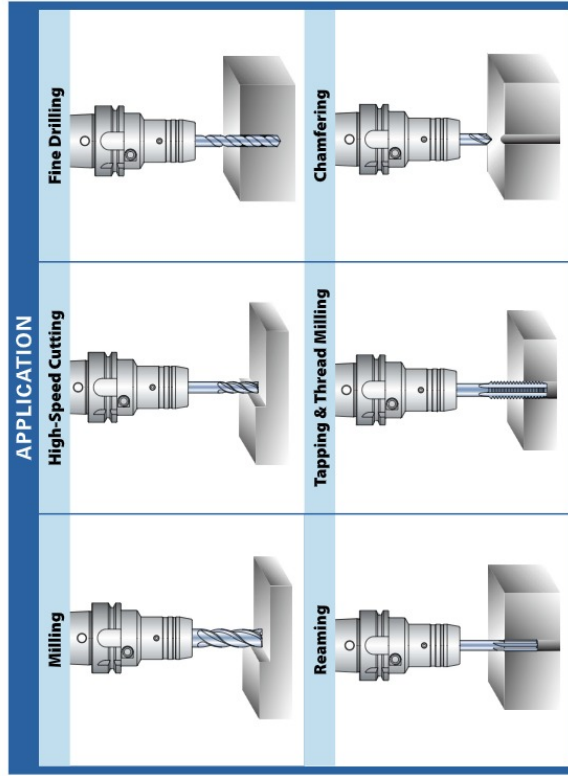
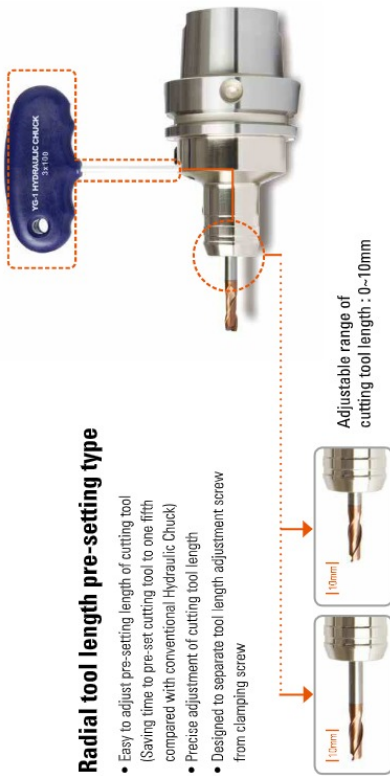

## HYDRAULIC CHUCK

### HYDRAULIC CHUCK (RADIAL TOOL LENGTH PRE-SETTING TYPE)

HCR

HYDRAULIK SPANNFUTTER (RADIALE WERKZEUGLÄGEN VOREINSTELLUNG):  
MANDRIN HYDRAULIQUE (BANC DE PRÉ-REGLAGE RADIAL)  
MANDRINI IDRAULICI (UTENSILI RADIALI PER AZZERAMENTO)  
PORTA-HERRAMIENTAS HIDRAULICO (AJUSTE DE LONGITUD TIPO PRE-SETTING)

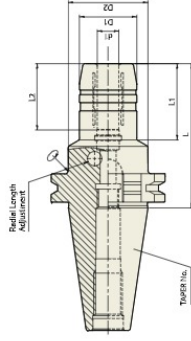

DIN 69871 -SK	Taper Accuracy	AT3	G Value	2.5	RPM	25,000	Run-Out (in 30)	≤31um	Coolant System	AD or AD/B
---------------	----------------	-----	---------	-----	-----	--------	-----------------	-------	----------------	------------

### ■ DIN 69871-SK

TAPER No.	MODEL No.	EDP No.	d1	D1	D2	L	L1	L2	Unit:mm
30	SK30-HCR12-85	P2770001A	12	32	44.5	85	40	37	WEIGHT (kg)
	SK30-HCR20-85	P2770003A	20	44	-	85	-	42	0.90
40	SK40AD/B-HCR12-80.5	P2554018	12	32	49.5	80.5	31.5	37	1.50
	SK40AD/B-HCR20-80.5	P2554019	20	42	49.5	80.5	34	42	1.60
50	SK50AD/B-HCR12-80.5	P2770004	12	32	80	110	50	55	2.20
	SK50AD/B-HCR20-80.5	P2770005	20	42	49.5	80.5	35	37	3.90
50	SK50AD/B-HCR20-80.5	P2770006	20	42	44.5	80.5	44	42	4.00
	SK50AD/B-HCR32-100	P2770002	32	60	-	100	-	55	4.70

▶ CATTANZI B5 50° taper and inch type products are available.  
▶ For applicable Hydraulic Chuck collet, please refer to page 42-45.

HYDRAULIC CHUCK

HYDRAULIC CHUCK (For GRINDER)

HYDRAULIK SPANNUTTER FÜR DEN FORMENBAU  
MANDRIN HYDRAULIQUE POUR MOULISTE  
MANDRINI IDRAULICI PER STAMPAGGIO  
PORTAHERRAMIENTAS HIDRAULICO PARA MOLDES

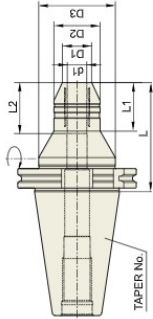

DIN 69871 -SK    Taper Accuracy AT3    Run-Out (at 30) <math>\le 3\mu m</math>    Coolant System AD

■ DIN 69871-SK

TAPER No.	MODEL No.	EDP No.	d1	D1	D2	D3	L	L1	L2	WEIGHT (kg)
50	SK50-HC6G-90	P2770951	6	14	30	63	90	30	27	3.00
	SK50-HC8G-90	P2770952	8	16	30	63	90	30	27	3.00
	SK50-HC10G-90	P2770953	10	18	30	63	90	30	32	3.00
	SK50-HC12G-90	P2770954	12	21	33	63	90	35	37	3.05
	SK50-HC14G-90	P2770955	14	22	35	63	90	35	37	3.10
	SK50-HC16G-90	P2770956	16	24	38	63	90	40	42	3.10
	SK50-HC18G-90	P2770957	18	26	40	63	90	40	42	3.10
	SK50-HC20G-110	P2770958	20	29	42	63	110	40	42	3.30
	SK50-HC25G-110	P2770959	25	34	50	70	110	45	48	3.60
	SK50-HC32G-110	P2770960	32	42	56	80	110	50	55	4.20

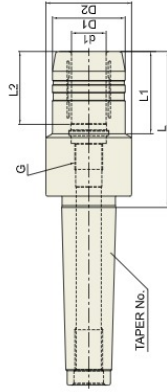

■ DIN 228-MTB

TAPER No.	MODEL No.	EDP No.	d1	D1	D2	L	L1	L2	G	WEIGHT (kg)
4	MTB4-HC20-90	P2770961	20	42	49.5	90	47.5	42	M16x1.0	1.30
	MTB4-HC32-90	P2770962	32	72	72	90	-	55	-	1.40
5	MTB5-HC20-90	P2770963	20	42	49.5	90	47.5	42	M16x1.0	2.20
	MTB5-HC32-90	P2770964	32	72	72	90	-	55	-	2.40

HYDRAULIC CHUCK

HCS

HYDRAULIC CHUCK SET **NEW**



MODEL No.	HYDRAULIC CHUCK	EDP No.	REDUCTION SLEEVE	WRENCH
HCS540-20	SK60AD/IB-HC20P-64.5	P2770971	HK20-6.8.10.12.16 (5pcs)	φ5mm
HCS840-20	BT60AD/IB-HC20P-72.5	P2770972	HK20-6.8.10.12.16 (5pcs)	φ5mm
HCSH40-20	HS663A-HC20P-80	P2770973	HK20-6.8.10.12.16 (5pcs)	φ5mm