

SK – KOMBI SHELL Prihvati

SHELL MILL ARBOR

COMBI-SHELL MILL ARBOR

KOMBI-AUFNAHMEDORN FÜR FRÄSER MIT BOHRUNG
MANDRIN PORTÉ-FRAISES COMBINÉS
MANDRINO PORTA FRESE
PORTA FRESAS COMBINADO

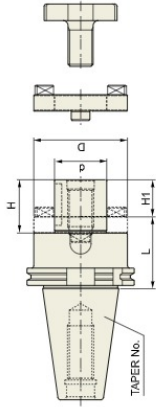

DIN 69871-SK

Taper Accuracy: AT3

G Value: 6.3

RPM: 15,000

Coolant System: A

■ DIN 69871-SK

◆ STANDARD

TAPER No.	MODEL No.	EDP No.	d	L	D	H1	H	Part No.	WEIGHT (kg)	Unit: mm
30	SK50-CMA16-50	P2524001	16	50	32	17	27	27, 33, 39		Unit: mm
	SK50-CMA22-50	P2524002	22	50	40	19	31	28, 34, 40		
	SK50-CMA27-55	P2524003	27	55	48	21	33	29, 35, 41		
40	SK60-CMA16-55	P2524004	16	55	32	17	27	27, 33, 39		Unit: mm
	SK60-CMA22-55	P2524005	22	55	40	19	31	28, 34, 40		
	SK60-CMA27-55	P2524006	27	55	48	21	33	29, 35, 41		
50	SK60-CMA32-60	P2524007	32	60	58	24	38	30, 36, 42		Unit: mm
	SK60-CMA40-60	P2524008	40	60	70	27	41	31, 37, 43		
	SK60-CMA16-55	P2524009	16	55	32	17	27	27, 33, 39		
50	SK60-CMA22-55	P2524010	22	55	40	19	31	28, 34, 40		Unit: mm
	SK60-CMA27-55	P2524011	27	55	48	21	33	29, 35, 41		
	SK60-CMA32-55	P2524012	32	55	58	24	38	30, 36, 42		
50	SK60-CMA40-55	P2524013	40	55	70	27	41	31, 37, 43		Unit: mm
	SK60-CMA50-70	P2524014	50	70	90	30	46	32, 38, 44		

◆ EXTENDED

TAPER No.	MODEL No.	EDP No.	d	L	D	H1	H	Part No.	WEIGHT (kg)	Unit: mm
40	SK40-CMA16-100	P2524015	16	100	32	17	27	27, 33, 39		Unit: mm
	SK40-CMA22-100	P2524016	22	100	40	19	31	28, 34, 40		
	SK40-CMA27-100	P2524017	27	100	48	21	33	29, 35, 41		
50	SK40-CMA32-100	P2524018	32	100	58	24	38	30, 36, 42		Unit: mm
	SK50-CMA16-100	P2524019	16	100	32	17	27	27, 33, 39		
	SK50-CMA22-100	P2524020	22	100	40	19	31	28, 34, 40		
50	SK50-CMA27-100	P2524021	27	100	48	21	33	29, 35, 41		Unit: mm
	SK50-CMA32-100	P2524022	32	100	58	24	38	30, 36, 42		
	SK50-CMA40-100	P2524023	40	100	70	27	41	31, 37, 43		

▶ CATIANSI BS.50 taper and inch type products are available.
▶ For parts, please refer to page 137.

SHELL MILL ARBOR

COMBI-SHELL MILL ARBOR

KOMBI-AUFNAHMEDORN FÜR FRÄSER MIT BOHRUNG
MANDRIN PORTÉ-FRAISES COMBINÉS
MANDRINO PORTA FRESE
PORTA FRESAS COMBINADO

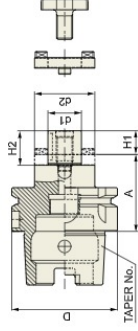

DIN 69893-HSK

Taper Accuracy: -

G Value: 6.3

RPM: 15,000

Coolant System: A

■ DIN 69893/ISO 12164-1-HSK FORM A

TAPER No.	MODEL No.	EDP No.	D	d1	d2	A	H1	H2	Part No.	WEIGHT (kg)	Unit: mm
50A	HSK50A-CMA16-50	P2562006	50	16	32	50	17	27	27, 33, 39		Unit: mm
	HSK50A-CMA22-50	P2562007	50	22	40	50	19	31	28, 34, 40		
	HSK50A-CMA27-65	P2562008	50	27	48	65	21	33	29, 35, 41		
63A	HSK63A-CMA32-65	P2562009	50	32	58	65	24	38	30, 36, 42		Unit: mm
	HSK63A-CMA16-60	P2562001	63	16	32	60	17	27	27, 33, 39		
	HSK63A-CMA22-60	P2562002	63	22	40	60	19	31	28, 34, 40		
63A	HSK63A-CMA27-60	P2562003	63	27	48	60	21	33	29, 35, 41		Unit: mm
	HSK63A-CMA32-60	P2562004	63	32	53	60	24	38	30, 36, 42		
	HSK63A-CMA40-70	P2562005	63	40	70	70	27	41	31, 37, 43		
100A	HSK100A-CMA16-60	P2562011	100	16	32	60	17	27	27, 33, 39		Unit: mm
	HSK100A-CMA22-60	P2562012	100	22	40	60	19	31	28, 34, 40		
	HSK100A-CMA27-60	P2562013	100	27	48	60	21	33	29, 35, 41		
100A	HSK100A-CMA32-60	P2562014	100	32	58	60	24	38	30, 36, 42		Unit: mm
	HSK100A-CMA40-70	P2562015	100	40	70	70	27	41	31, 37, 43		
100A	HSK100A-CMA50-80	P2562010	100	50	90	80	30	46	32, 38, 44		Unit: mm

▶ For parts, please refer to page 137.